

VectorWorks Landmark Case Study: Various Projects

Adam Thomas - Landscape Designer

adam thomas • landscape design

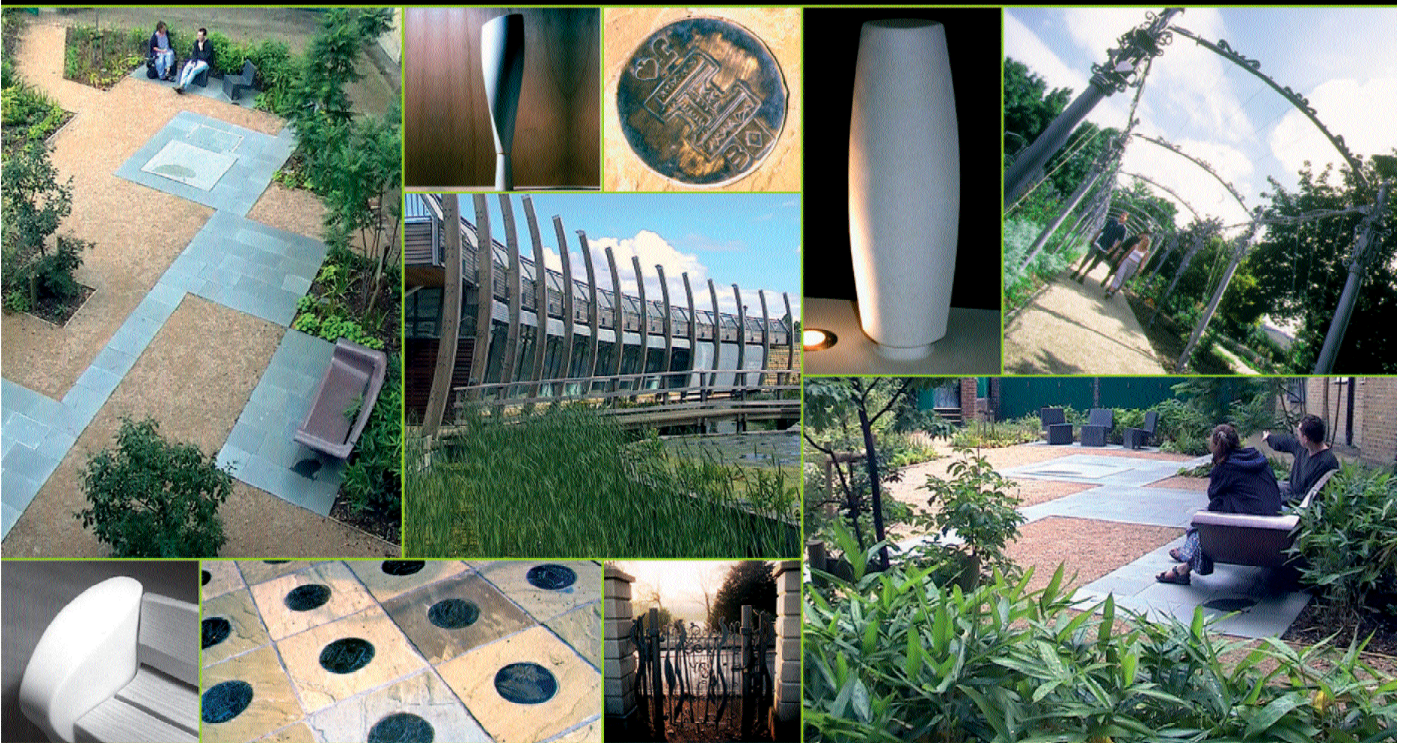

22 foyle road, london se3 7rh
t: 020 8293 1871 • e: info@adamthomas.net

VectorWorks Landmark Case Study: Various Projects

Adam Thomas - Landscape Designer

I have used and taught VectorWorks for over a decade working for local authorities, private practice and as a self employed landscape architect. and have found it to be exceptional value and extremely capable. Recently I have been using it in an architectural company dominated by autocad so had to get myself trained in that program. The functionality of VectorWorks for design, and in particular non geometric, freeform design, was not explored, and I happily stay in my VectorWorks world, importing and exporting as needed.

More usually I have worked in smaller practices and as a sole trader, and the huge advantage of VectorWorks is that it gives so much flexibility within one package.

Here are a range of projects from small improvements to schools to large scale parks and new build projects.

At the ideas / concept stage it can act as a desk-top publishing package for combining and creating images, plans and text for public consultations, school displays, ideas boards etc. I have used this for linking images created with Renderworks or the DTM modeller to Sheet Layers, which can allow multiple views of the same model. I also have thrown up very basic 3D models of the sites and traced over, putting people, trees and colour in by hand, before re-scanning and adding to image boards.

GREENING VAUXHALL
 Role : Consultant Landscape Architect on three parks in Vauxhall
 Client : London Borough of Lambeth
 Responsibilities: Consultation, design and project management.
 Working with local authority officers, project managers (Faithful & Gould and highway engineers (Atkins) on area improvements' scheme
 Value : Approx. £200,000 each park.
 Contractor : Blakedown; Norwest Host / English Landscapes

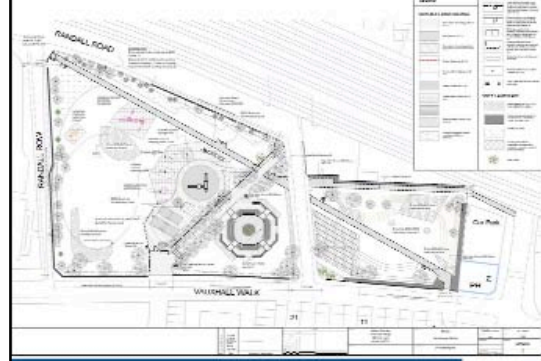

Pedlars Park Start on Site August 2006



Lambeth Walk - Completed March 2006



- Move the boundaries to create one large open space.
- New paths to link the Pedlars Park and Saltram space
- Removing the back railings to bring the path alongside the vicaruct with in the park
- New play and games facilities for all ages
- A toddlers and quiet seating area.
- New signage, planting and artwork



Lambeth High Street Start on Site October 2006



- Re-locating the main entrance to the park
- Laying a garden of remembrance
- Creating wild flowers areas
- Refurbishing the water feature
- Improving the play area and creating a 'copy' tree zone
- Re-installing the listed boundary walls
- Renewing all furniture and surfaces

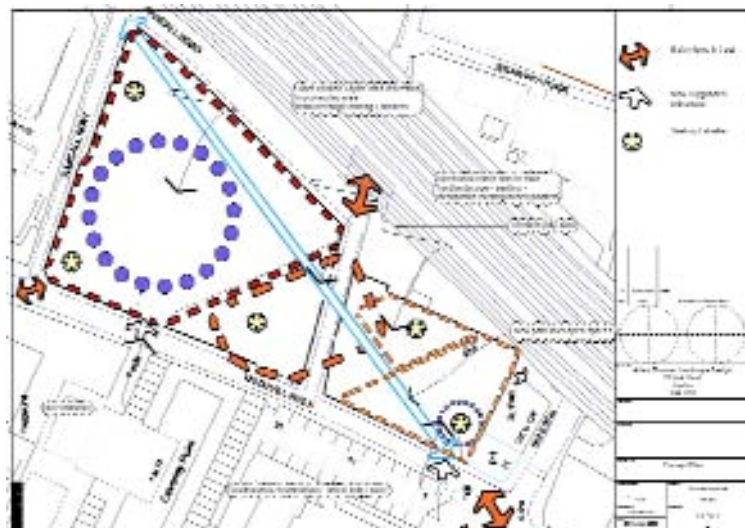

The combination of layers, classes and sheets makes creating complete projects within a file very easy and enables quick cross-referencing to other drawings and the tool palettes enable complex, organic shapes to be easily created and edited.

Combining 3D elements for complex details can greatly clarify communications with contractors and enable clients to visualise the final product.

Linking all of this with the plant database streamlines the process. The time saving in creating, and in particular editing, large planting plans is enormous.

Adam Thomas

Mile End Park Millennium Project

CLU Ltd / ATLD

Role: Leading landscape team on north parkland; working with masterplanners (TM2), architects to green bridge (CZWG), civil and structural engineers and local authority landscape architects.

Client : Millennium Commission; LB Tower Hamlets;

Responsibilities : Developing and coordinating design work to Ecology park, Art park, Play Arena and Green Bridge

Detail design to Ecology and Art parks

Total Project Value 24m

Landscape (North) Approx. 2m

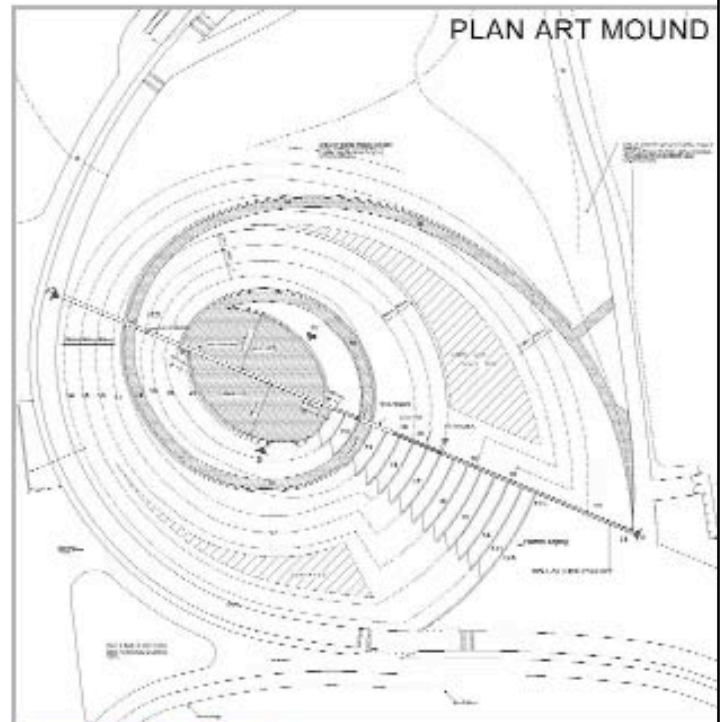
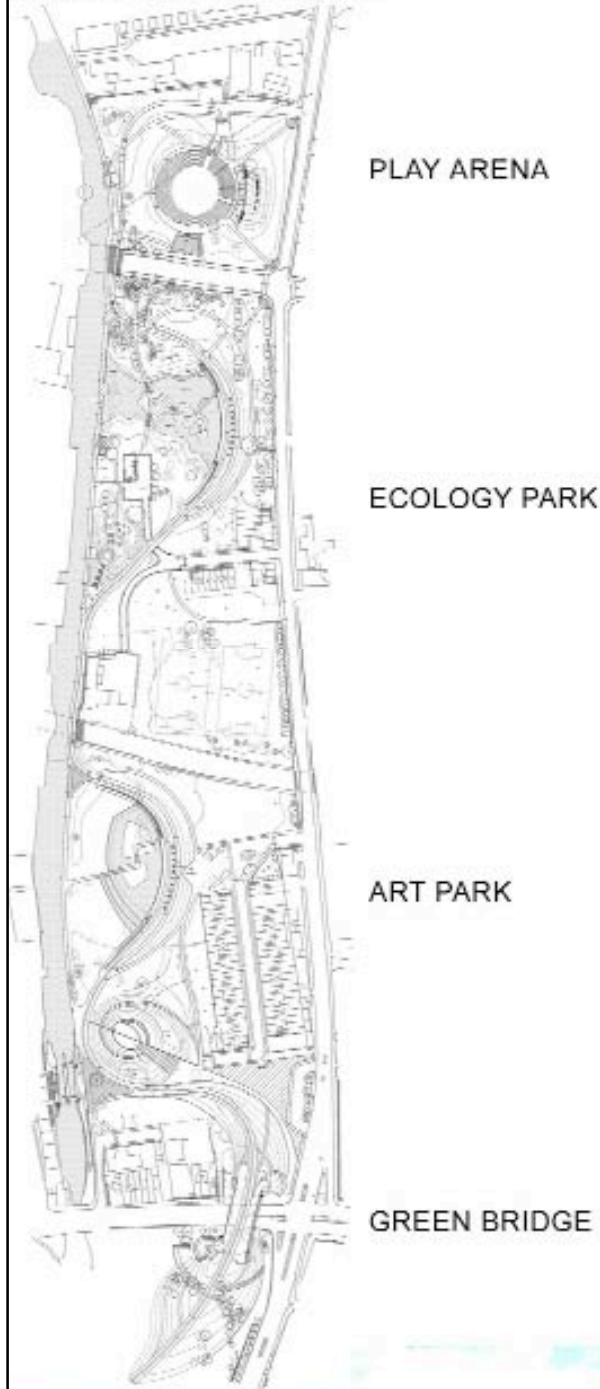

VectorWorks Case Study: Adam Thomas - Landscape Designer

TOP OF POST DETAIL 1:10



10mm thick galvanized steel sleeve for cable to run through - rounded at each end

DETAIL 1:10

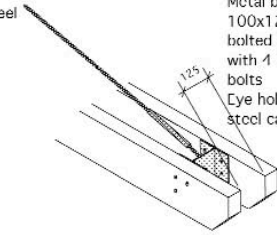

Metal bracket to be 100x125x80x4mm bolted to timber beams with 4 No 50mm galvanized bolts Eye hole on side to receive steel cable

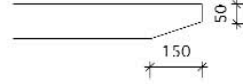

PLAN 1:50

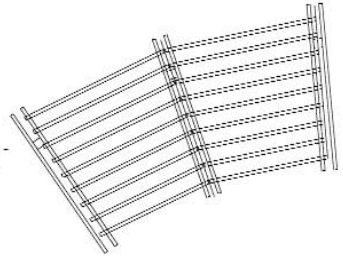

50x75 pressure treated softwood timbers - cut to fit.
Nailed at angles through sides - 75mm galvanized nails - 2 per junction

ELEVATION 1:20

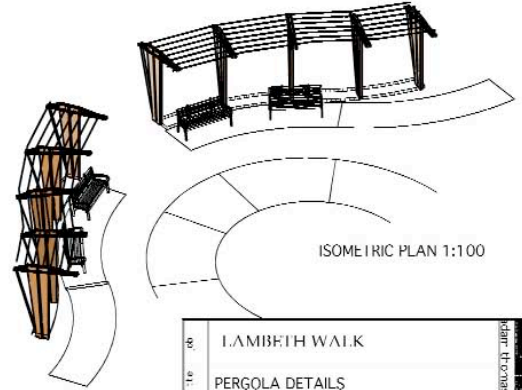
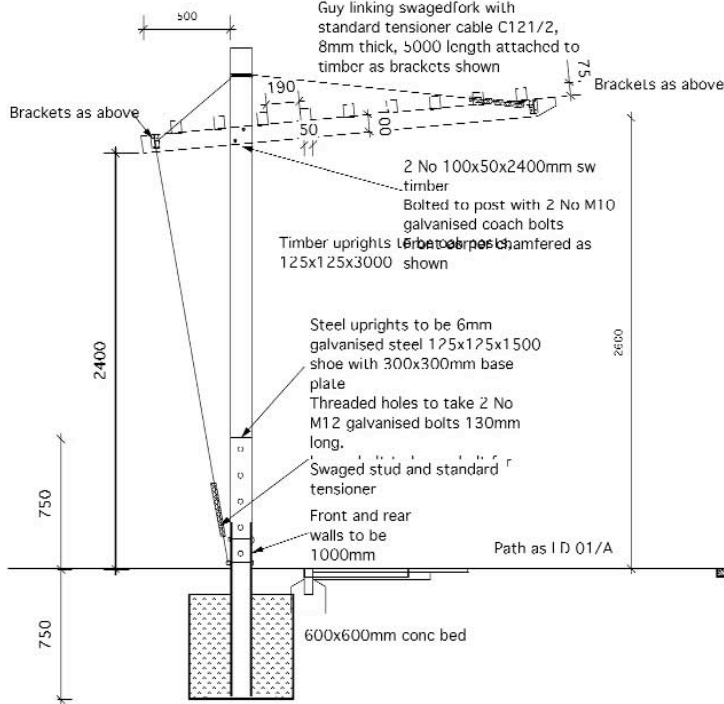

ISOMETRIC PLAN 1:100

LAMBETH WALK	
PERGOLA DETAILS	
1:10/1:20/1:50	4/10/04
LD 07	04/02/LW
22 foyle road london se3 7rh t: 0208 293 1884	
f: 0870 0362461 e: info@adamthomas.net	

PLAN ELEVATION AND SECTIONS - 1:25

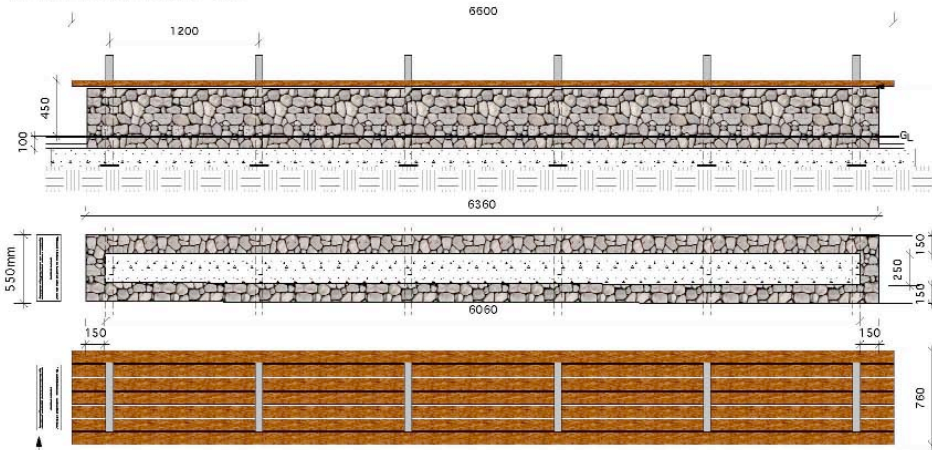

General Note:

Do not scale from this drawing, use figured dimensions only. Any discrepancies to be brought to the attention of the Landscape Architect prior to the start of work on site.

In situ conc. to be clad with limestone wall with blocks re-used from excavations 150mm thick on conc. strip foundation.

Mortar joints to be recessed and kept to a maximum of 10mm as far as is practicable

Stainless steel plaque to be same width as stone base

DETAIL - 1:10

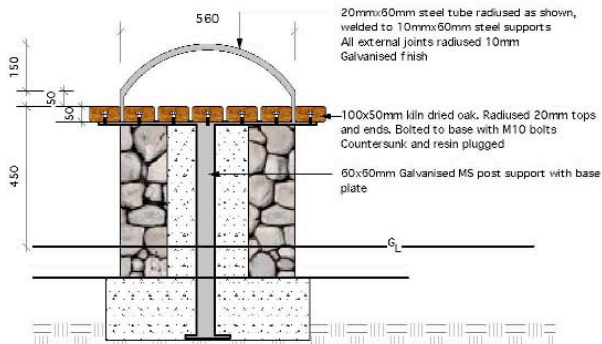

PLAQUE - N.T.S.

"I like work: it fascinates me. I can sit and look at it for hours."

(Lewis Carroll - Alice's Adventures Under Ground)

The limestone used to construct this seat has been re-cycled from the demolition of the Slipper Baths which were located on the site of Walsal College of Art and Technology

Plaque to be stainless steel. Suggested text above Set in conc to engineers specification flush with surface of paving. Width to be @550 as width of stone seat base

1:10 (120) 1:10/1:20/1:50

